

PLAN OF STP  
SCALE - 1 : 100

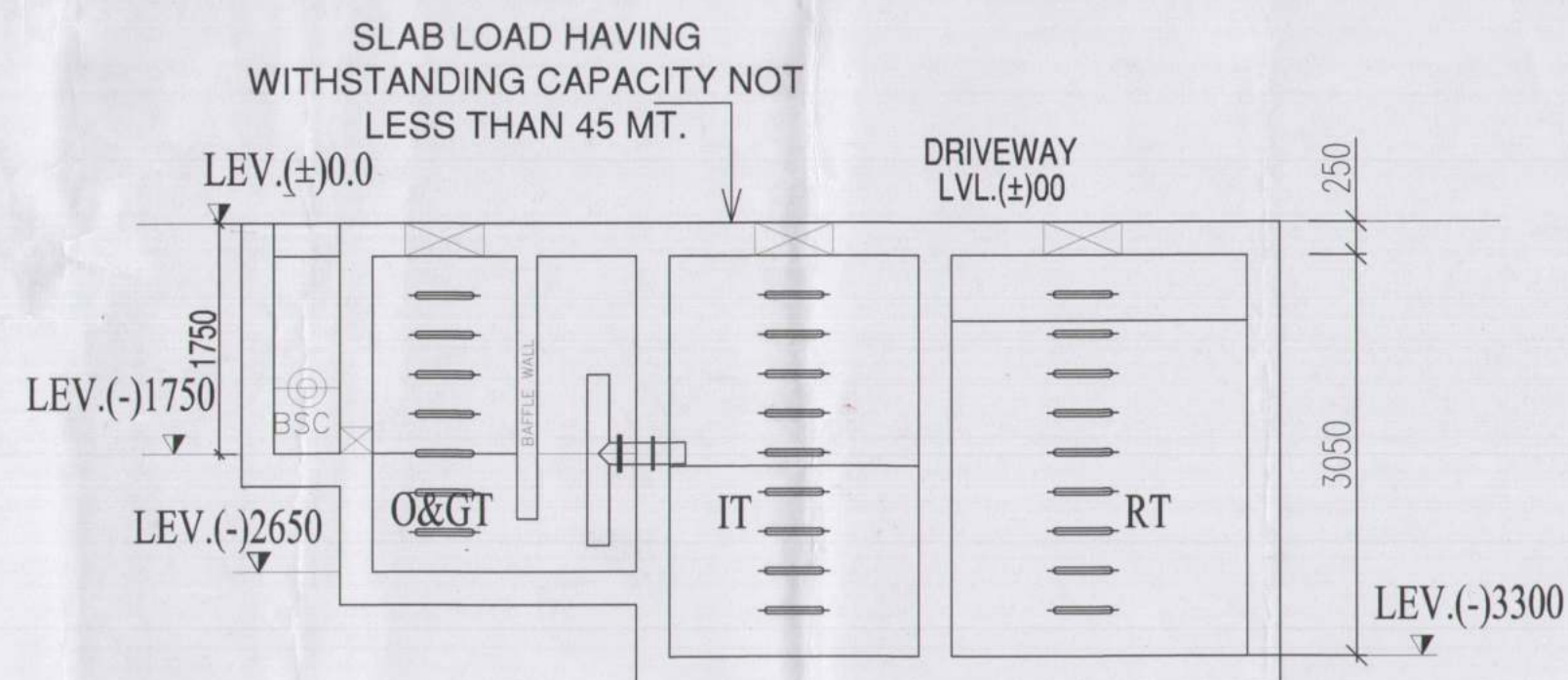

SECTION - Y-Y  
SCALE - 1 : 100

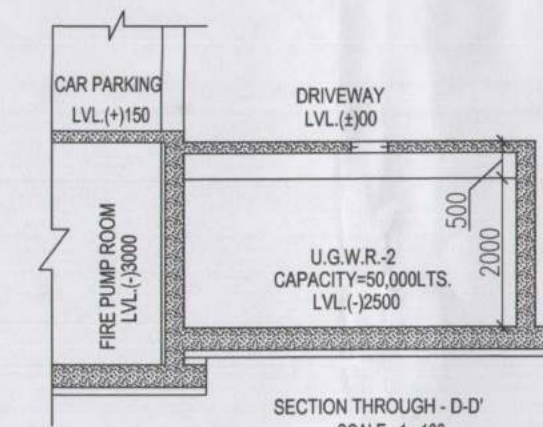

PLACED IN THE BUILDING COMMITTEE MEETING  
HELD ON 08-10-2020 RECOMMENDED

Passed in the meeting of Board of Administrator  
Held on 05-01-21

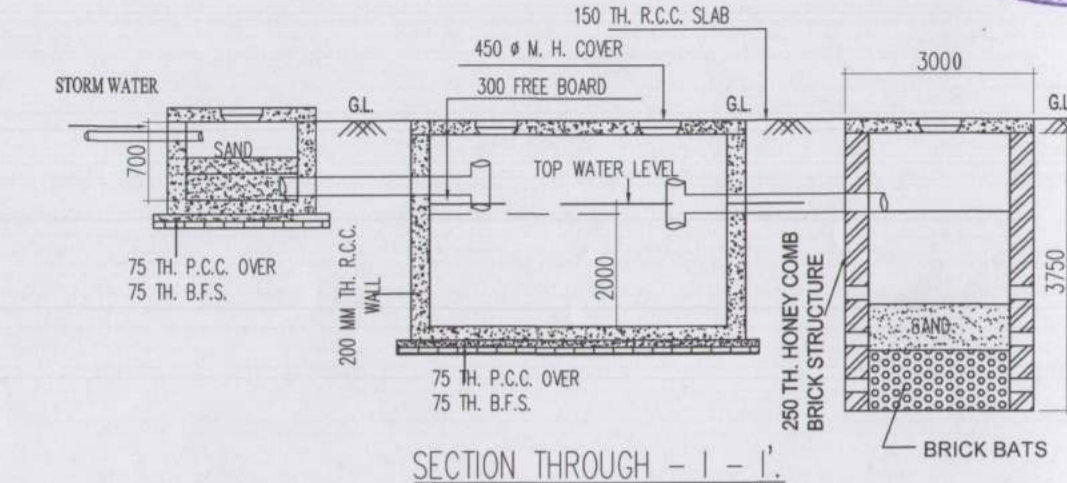
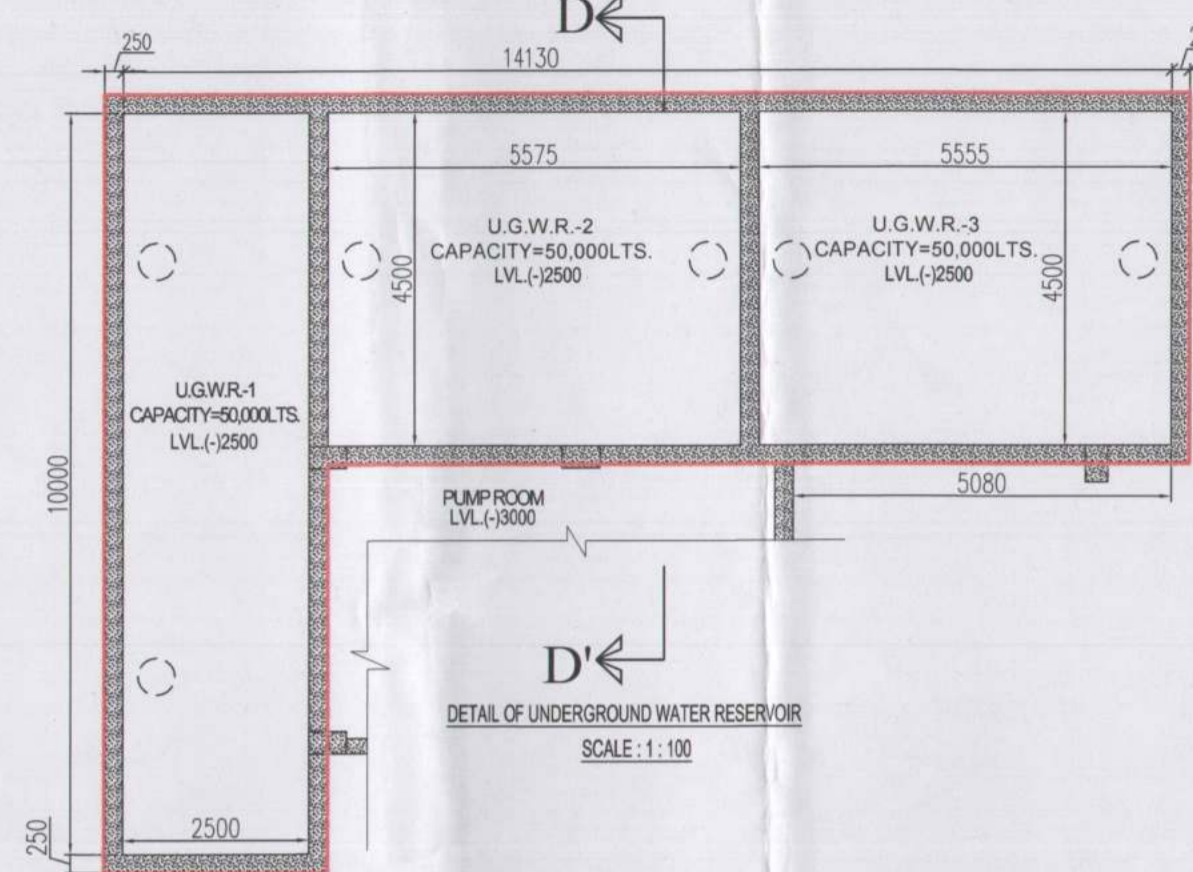

SECTION THROUGH - I-I  
SCALE - 1 : 100

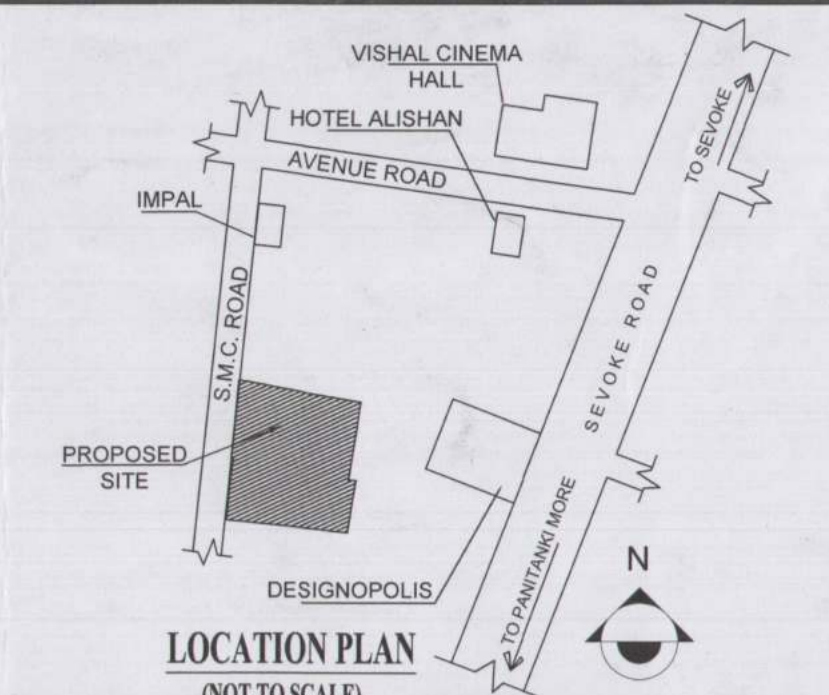
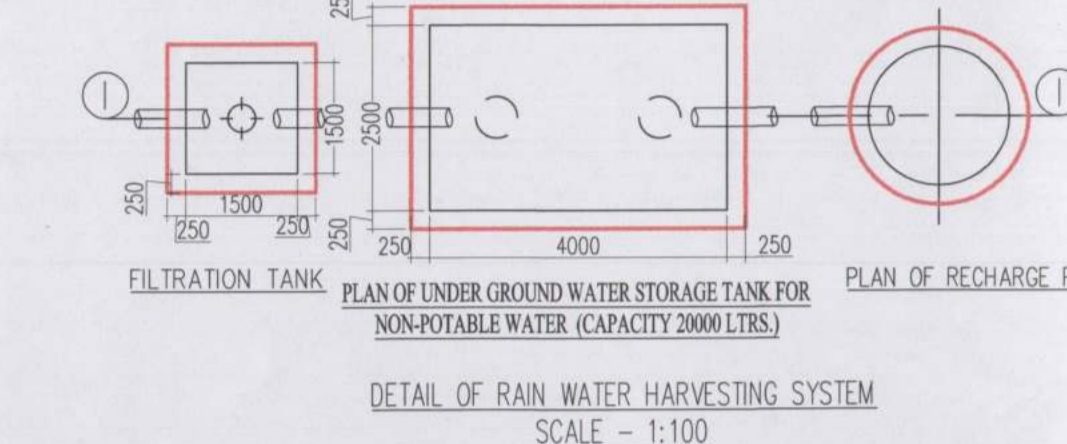

PROJECT: PROPOSED GROUND + 7 STORED RESIDENTIAL CUM COMMERCIAL BUILDING

NAME OF OWNERS: 1. RAVINDAR AGARWAL  
2. SURENDRA K.P. AGARWAL  
3. SIMA AGARWAL  
4. BIMLA DEVI AGARWAL  
5. JITEN AGARWAL  
6. UMESH KUMAR KEDIA  
7. KRISHAN KUMAR AGARWAL  
8. TANUJ AGARWAL

LOCATION: KABI BHANUBHAKTA PATH, SILIGURI.

SCHEDULE OF LAND:  
MOUZA :- DABGRAM  
J.L. NO :- 02  
SHEET NO :- R.S. 8 & L.R. 13  
KHATIAN NO :- R.S. 314,314/5, L.R. 34,35,36,37,38, 162,163,164,165,166  
PLOT NO :- R.S. 421 & L.R. 126,129 & 130  
PARGANA :- BAIKANTHAPUR  
WARD NO :- 43  
P.S. :- BHAKTINAGAR.  
DIST. :- JALPAIGURI.  
HOLDING NO. :- N / 56 / 2688 , VL / 100 / C/43 , 96 / N / 124

AREA STATEMENT

1. AREA OF LAND (AS PER DEED)	:- 4186.960 sq.mt
2. AREA OF LAND (AS PER SITE)	:- 4027.761 sq.mt
3. PERMISSIBLE GROUND COVERAGE	:- 2013.881 sq.mt (50.00%)
4. PROPOSED GROUND COVERAGE	:- 1797.282 sq.mt (44.82 %)
5. PUMP ROOM AREA (LVL -3000)	:- 27.183 SQ.M.
6. GROUND FLOOR AREA	:- 1779.417 SQ.M.
7. 1ST FLOOR AREA	:- 821.768 SQ.M.
8. TYPICAL(2ND TO 6TH) FLOOR AREA	:- 1356.214 SQ.M. (EACH)
9. 7TH FLOOR AREA	:- 1284.708 SQ.M.
10. TOTAL FLOOR AREA	:- 10694.146 SQ.M.
11. PERMISSIBLE F.A.R.	:- 2.250
12. PROPOSED F.A.R.	:- 2.246
13. TOTAL RESIDENTIAL AREA	:- 9996.196 SQ.M.
14. TOTAL TENEMENT AREA	:- 7194.951 SQ.M.
15. TOTAL COMMERCIAL AREA AT GROUND FLOOR	:- 697.950 SQ.M. (6.53 % OF T.F.A.)
16. PERMISSIBLE HEIGHT OF BUILDING	:- 40.00 M.
17. PROPOSED HEIGHT OF BUILDING	:- 25.40 M.
18. NO. OF TENEMENT	:- 51 nos.
19. GREEN AREA REQUIRED	:- 604.164 SQ.M. (15.00%)
20. GREEN AREA PROPOSED	:- 623.940 SQ.M. (15.49%)
21. OCCUPANCY OF LAND	:- RESIDENTIAL CUM COMMERCIAL
22. OCCUPANCY/USE OF BUILDING	:- RESIDENTIAL
23. APPROVED U.L.C.C. MEMO NO.	:- 4223/SJDA DATE - 19.03.2020

Signature of Owner(s): Ravinder Agarwal, Surendra Agarwal, Seema Agarwal.  
Signature of Attorney: RAHJANA AGARWAL (As Constituted Attorney of 1. BIMLA DEVI AGARWAL, 2. JITEN AGARWAL, 3. UMESH KUMAR KEDIA, 4. KRISHAN KUMAR AGARWAL, 5. TANUJ AGARWAL)

SIGNATURE OF OWNER(S)

SIGNATURE OF GEO. TECHNICAL ENGS. (Signature of Sanjay Chatterjee)  
SIGNATURE OF STRUCTURAL ENGS. (Signature of Sanjay J. Parekh)

SIGNATURE OF ARCHITECT / L.B.S. (Signature of Mitul Shukla)

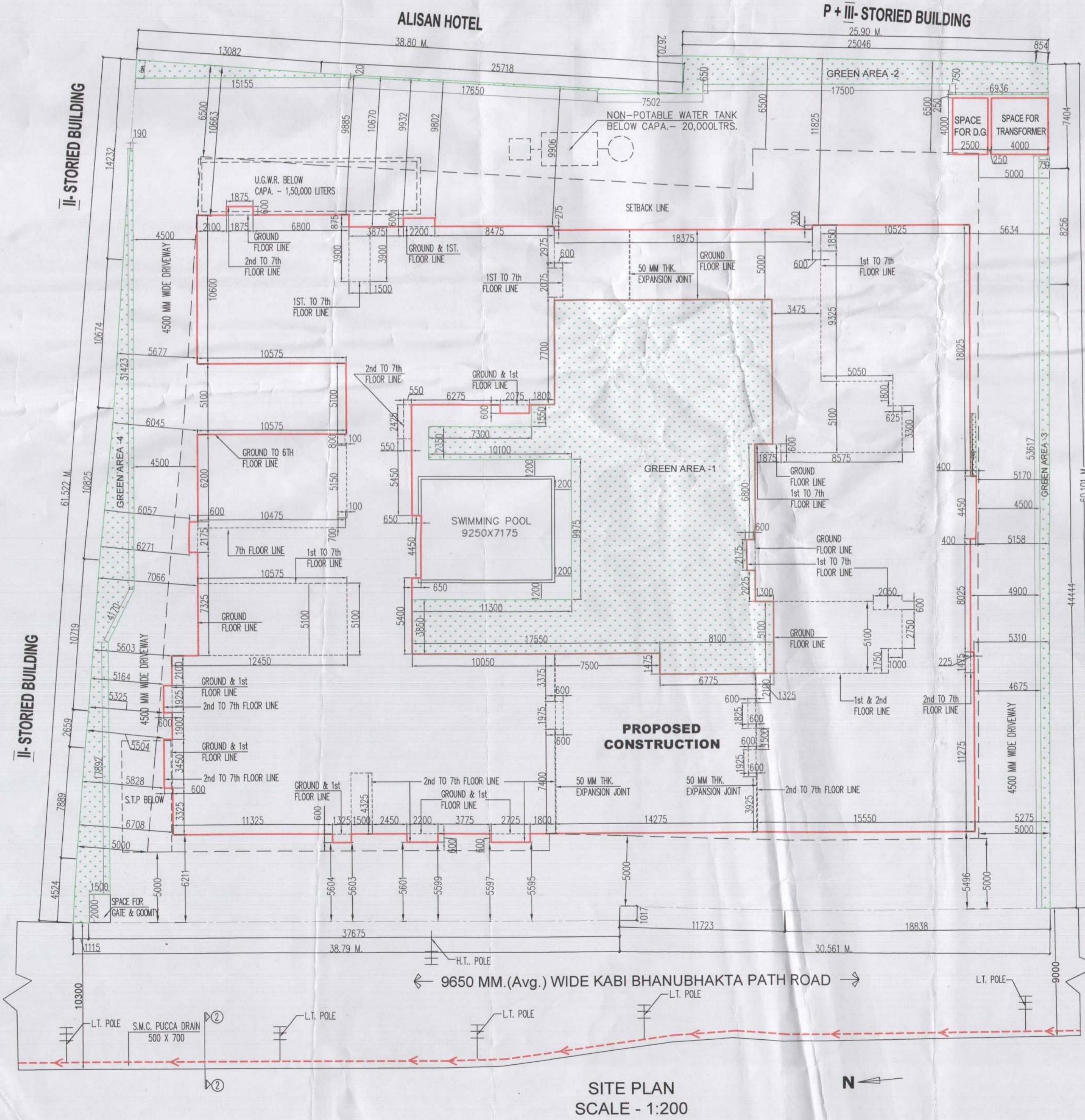

SITE PLAN  
SCALE - 1 : 200

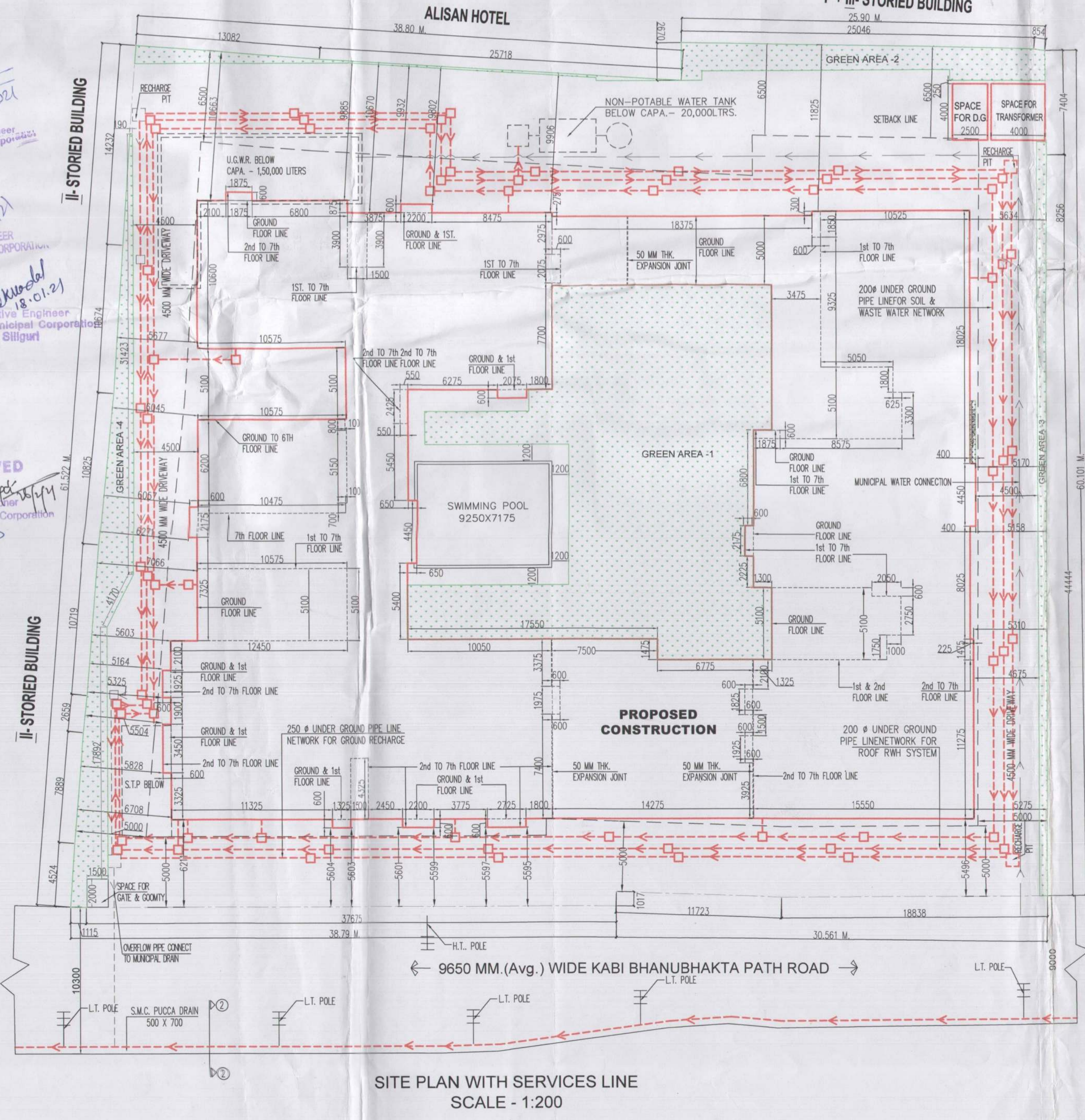

SITE PLAN WITH SERVICES LINE  
SCALE - 1 : 200

Approved 09/01/2021  
Sub-Asstt. Engineer  
Siliguri Municipal Corporation

Approved 18/01/21  
Executive Engineer  
Siliguri Municipal Corporation

APPROVED  
Commissioner  
Siliguri Municipal Corporation

TIN SHADE GODOWN (HT. APPROX. 3.6 M.)

TIN SHADE GODOWN (HT. APPROX. 3.6 M.)